

JAD SERIES

All Electric Servo Drive
Injection Molding Machine



Specifications

Model	J35AD J55AD J85AD J110AD J140AD J180AD
-------	---

JSW

Performance Table

Unit	Model	J35AD					
		15H			30H		
Item							
Screw cylinder type		K	A	B	K	A	B
Screw diameter	mm	16	18	20	20	22	25
Screw stroke	mm	60			80		
Theoretical injection capacity	cm ³	12	15	18	25	30	39
Injection capacity (GP-PS)	g	11	14	17	23	28	38
Standard	Injection pressure(Max.) MPa {kgf/cm ² }	276 {2810}	218 {2220}	177 {1800}	270 {2750}	223 {2270}	172 {1750}
	Holding pressure(Max.) MPa {kgf/cm ² }	251 {2560}	198 {2010}	161 {1640}	245 {2490}	203 {2070}	157 {1600}
	Injection speed	350			350		
	Injection rate	70	89	110	110	133	172
	Plasticizing rate (GP-PS) kg/h	10	14	17	17	21	28
	Screw speed	500			500		
	Injection Unit High speed (HS)	Injection pressure(Max.) MPa {kgf/cm ² }	276 {2810}	218 {2220}	177 {1800}	270 {2750}	223 {2270}
Holding pressure(Max.) MPa {kgf/cm ² }		251 {2560}	198 {2010}	161 {1640}	245 {2490}	203 {2070}	157 {1600}
Injection speed		550			550		
Injection rate		111	140	173	173	209	270
Plasticizing rate (GP-PS) kg/h		10	14	17	17	21	28
Screw speed		500			500		
Ultra speed (US)	Injection pressure(Max.) MPa {kgf/cm ² }	276 {2810}	218 {2220}	177 {1800}	270 {2750}	223 {2270}	172 {1750}
	Holding pressure(Max.) MPa {kgf/cm ² }	251 {2560}	198 {2010}	161 {1640}	245 {2490}	203 {2070}	157 {1600}
	Injection speed	800			800		
	Injection rate	161	204	251	251	304	393
	Plasticizing rate (GP-PS) kg/h	10	14	17	17	21	28
	Screw speed	500			500		
Nozzle touch force	kN {tf}	9.9 {1.0}			14.8 {1.5}		
Nozzle stroke from platen	mm	50					
Type of nozzle		Open nozzle					
Cylinder temperature control		Cylinder 3 / Nozzle 2					
Heater wattage	kW	3.1			3.9		
Clamping Unit	Mechanism	Double toggle					
	Clamping force	kN {tf} 344 {35}					
	Daylight opening (Max.)	mm 560					
	Opening stroke (Max.)	mm 230					
	Mold height	mm 150~330					
	Distance between tie-bars (H×V)	mm 310×290					
	Platen size (H×V)	mm 450×430					
	Ejector point	3 points					
	Ejector force	kN {tf} 9.9 {1.0}					
Ejector stroke	mm 50						
General	Machine weight	t 2.5			t 2.6		
	Machine dimensions (L×W×H) m	3.21×1.01×1.58			3.23×1.01×1.58		

Remarks:

- Maximum injection pressure and maximum holding pressure may be restricted due to molding condition.
- The theoretical injection capacity is (cross sectional area of cylinder) × (stroke of screw).
- The injection capacity is applicable for GP-PS and variable according to the grade of resin, molding conditions and mold.
- The plasticizing rate is applicable for GP-PS.
- PC, HPVC, other engineering plastic, etc., low temperature setting and high speed molding may require a high torque depending on the grade or molding conditions. Please contact us if you plan.

Note:

- Due to continual improvements, specifications are subject to change without notice.
- Actual figures of the specification will vary depending on final machine configuration. Please contact us if you require more specific data.
- Performance specifications are based on theoretical data.
- High speed injection and Ultra speed injection are optional.
- 1MPa=10.2 kgf/cm², 1kN=0.102tf

Equipment Dimensions and Mold Related Dimensions

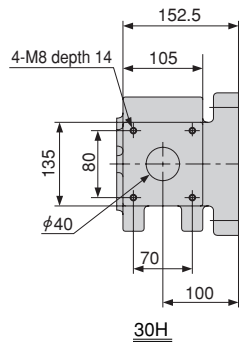
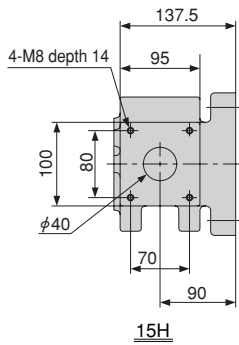
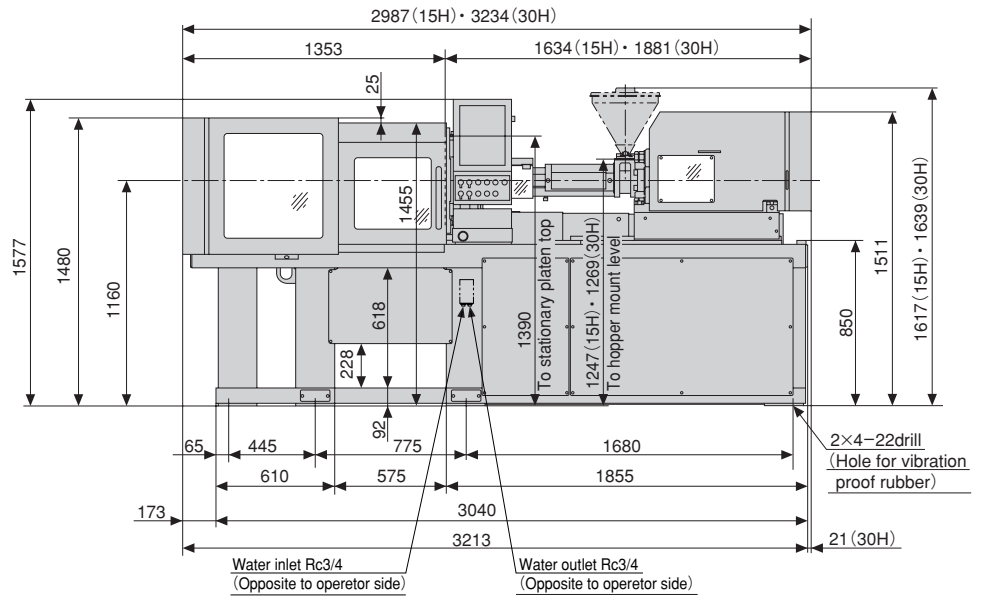
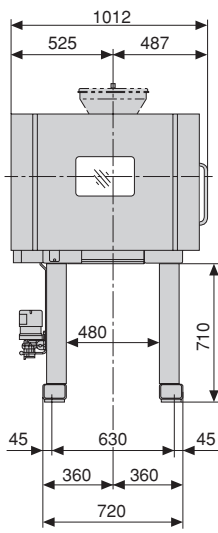

Hopper mount

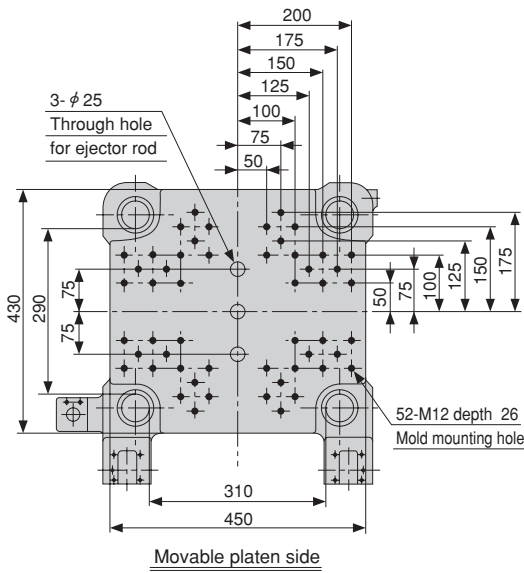
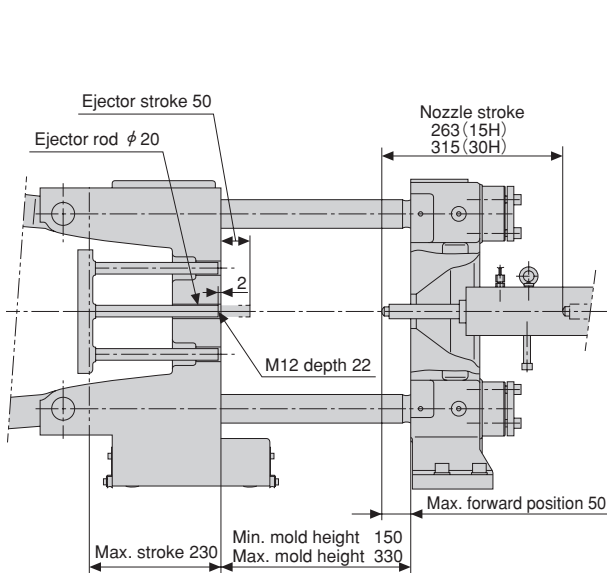
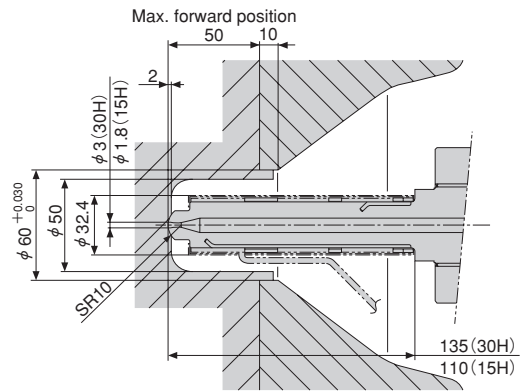

Movable platen side

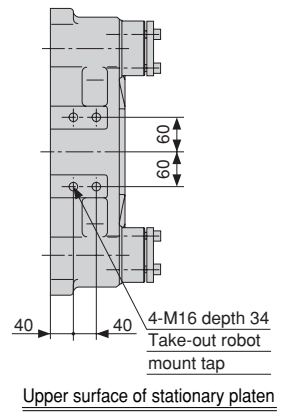

Upper surface of stationary platen

Performance Table

Unit	Model	J55AD								
		15H			30H			60H		
Item		K	A	B	K	A	B	K	A	B
Screw cylinder type		K	A	B	K	A	B	K	A	B
Screw diameter	mm	16	18	20	20	22	25	25	28	32
Screw stroke	mm	60			80			100		
Theoretical injection capacity	cm ³	12	15	18	25	30	39	49	62	80
Injection capacity (GP-PS)	g	11	14	17	23	28	38	45	56	73
Standard	Injection pressure(Max.) MPa(kgf/cm ²)	276 {2810}	218 {2220}	177 {1800}	270 {2750}	223 {2270}	172 {1750}	270 {2750}	215 {2190}	165 {1680}
	Holding pressure(Max.) MPa(kgf/cm ²)	251 {2560}	198 {2010}	161 {1640}	245 {2490}	203 {2070}	157 {1600}	245 {2490}	195 {1980}	150 {1530}
	Injection speed	350			350			350		
	Injection rate	70	89	110	110	133	172	172	216	281
	Plasticizing rate (GP-PS) kg/h	10	14	17	17	21	28	34	46	74
	Screw speed	500			500			400		
	Injection Unit High speed (HS)	Injection pressure(Max.) MPa(kgf/cm ²)	276 {2810}	218 {2220}	177 {1800}	270 {2750}	223 {2270}	172 {1750}	270 {2750}	215 {2190}
Holding pressure(Max.) MPa(kgf/cm ²)		251 {2560}	198 {2010}	161 {1640}	245 {2490}	203 {2070}	157 {1600}	245 {2490}	195 {1980}	150 {1530}
Injection speed		550			550			500		
Injection rate		111	140	173	173	209	270	245	308	402
Plasticizing rate (GP-PS) kg/h		10	14	17	17	21	28	34	46	74
Screw speed		500			500			400		
Ultra speed (US)	Injection pressure(Max.) MPa(kgf/cm ²)	276 {2810}	218 {2220}	177 {1800}	270 {2750}	223 {2270}	172 {1750}	270 {2750}	215 {2190}	165 {1680}
	Holding pressure(Max.) MPa(kgf/cm ²)	251 {2560}	198 {2010}	161 {1640}	245 {2490}	203 {2070}	157 {1600}	245 {2490}	195 {1980}	150 {1530}
	Injection speed	800			800			800		
	Injection rate	161	204	251	251	304	393	393	493	643
	Plasticizing rate (GP-PS) kg/h	10	14	17	17	21	28	34	46	74
	Screw speed	500			500			400		
Nozzle touch force	kN {tf}	9.9 {1.0}			14.8 {1.5}			14.8 {1.5}		
Nozzle stroke from platen	mm	50								
Type of nozzle		Open nozzle								
Cylinder temperature control		Cylinder 3 / Nozzle 2						Cylinder 4 / Nozzle 2		
Heater wattage	kW	3.1			3.9			5.5		
Clamping Unit	Mechanism	Double toggle								
	Clamping force	540 {55}								
	Daylight opening (Max.)	630								
	Opening stroke (Max.)	260								
	Mold height	160~370								
	Distance between tie-bars (H×V)	360×310								
	Platen size (H×V)	520×470								
	Ejector point	5 points								
Ejector force	20 {2.0}									
Ejector stroke	70									
General	Machine weight	3.0			3.1			3.1		
	Machine dimensions (L×W×H) m	3.54×1.05×1.58			3.54×1.05×1.58			3.66×1.05×1.58 (US 3.78×1.05×1.58)		

Remarks:

- Maximum injection pressure and maximum holding pressure may be restricted due to molding condition.
- The theoretical injection capacity is (cross sectional area of cylinder) × (stroke of screw).
- The injection capacity is applicable for GP-PS and variable according to the grade of resin, molding conditions and mold.
- The plasticizing rate is applicable for GP-PS.
- PC, HPVC, other engineering plastic, etc., low temperature setting and high speed molding may require a high torque depending on the grade or molding conditions. Please contact us if you plan.

Note:

- Due to continual improvements, specifications are subject to change without notice.
- Actual figures of the specification will vary depending on final machine configuration. Please contact us if you require more specific data.
- Performance specifications are based on theoretical data.
- High speed injection and Ultra speed injection are optional.
- 1MPa=10.2 kgf/cm², 1kN=0.102tf

Equipment Dimensions and Mold Related Dimensions

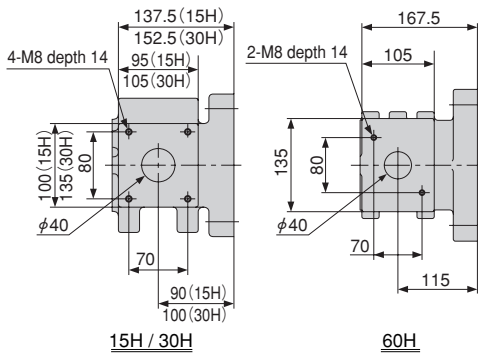
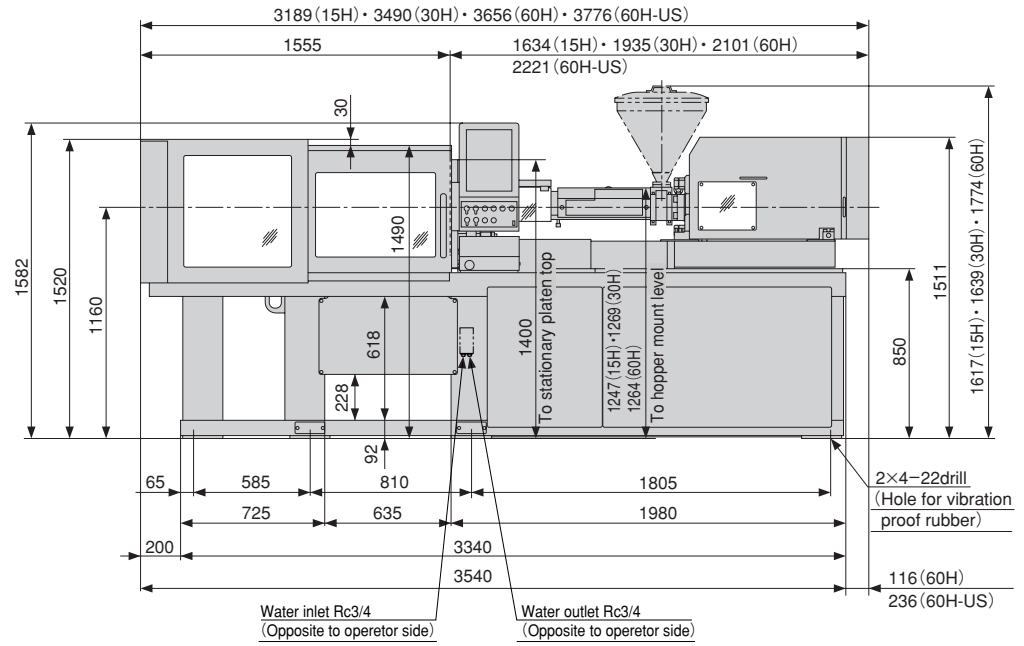
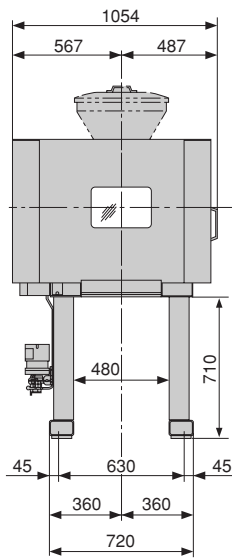

Hopper mount

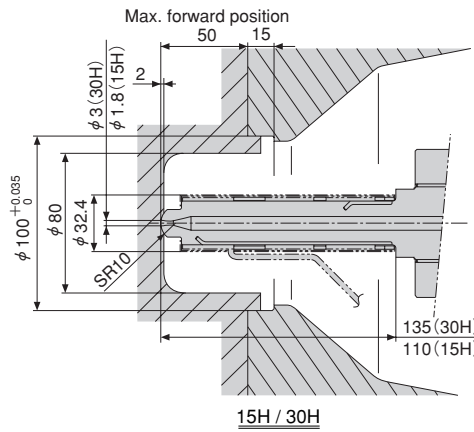

15H / 30H

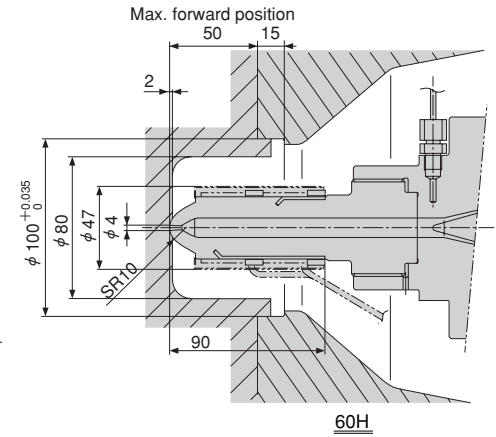

60H

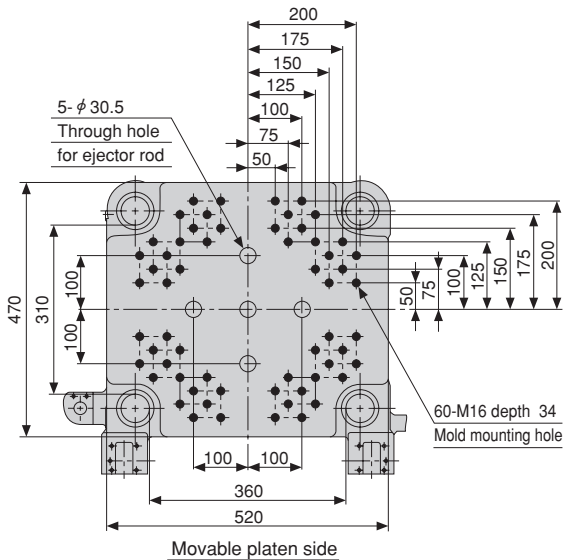
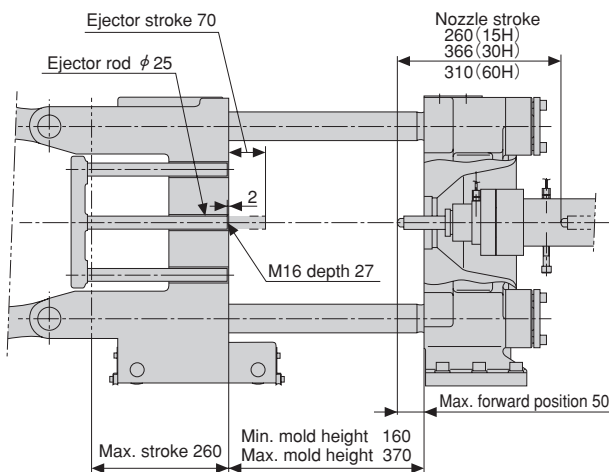

Movable platen side

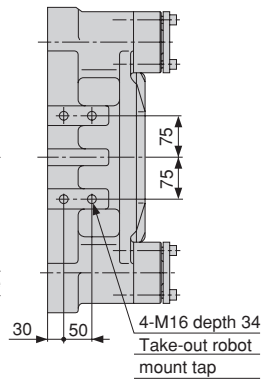

Upper surface of stationary platen

Performance Table

Unit	Item	Model									
		30H			60H			110H			
General Unit	Screw cylinder type	K	A	B	K	A	B	K	A	B	
	Screw diameter mm	20	22	25	25	28	32	32	35	40	
	Screw stroke mm	80			100			120			
	Theoretical injection capacity cm ³	25	30	39	49	62	80	97	115	151	
	Injection capacity (GP-PS) g	23	28	38	45	56	73	88	105	137	
	Standard	Injection pressure(Max.) MPa(kgf/cm ²)	270 {2750}	223 {2270}	172 {1750}	270 {2750}	215 {2190}	165 {1680}	270 {2750}	225 {2290}	172 {1750}
		Holding pressure(Max.) MPa(kgf/cm ²)	245 {2490}	203 {2070}	157 {1600}	245 {2490}	195 {1980}	150 {1530}	245 {2490}	205 {2090}	157 {1600}
		Injection speed mm/s	350			350			350		
		Injection rate cm ³ /s	110	133	172	172	216	281	281	337	440
		Plasticizing rate (GP-PS) kg/h	17	21	28	34	46	74	74	92	123
		Screw speed min ⁻¹	500			400			400		
		Injection Unit	High speed (HS)								
	Injection pressure(Max.) MPa(kgf/cm ²)		270 {2750}	223 {2270}	172 {1750}	270 {2750}	215 {2190}	165 {1680}	—	—	—
	Holding pressure(Max.) MPa(kgf/cm ²)		245 {2490}	203 {2070}	157 {1600}	245 {2490}	195 {1980}	150 {1530}	—	—	—
	Injection speed mm/s		550			500			—		
	Injection rate cm ³ /s		173	209	270	245	308	402	—	—	—
	Ultra speed (US)	High speed (HS)									
		Injection pressure(Max.) MPa(kgf/cm ²)	270 {2750}	223 {2270}	172 {1750}	270 {2750}	215 {2190}	165 {1680}	—	—	—
		Holding pressure(Max.) MPa(kgf/cm ²)	245 {2490}	203 {2070}	157 {1600}	245 {2490}	195 {1980}	150 {1530}	—	—	—
		Injection speed mm/s	800			800			—		
		Injection rate cm ³ /s	251	304	393	393	493	643	—	—	—
	Clamping Unit	Plasticizing rate (GP-PS) kg/h	17	21	28	34	46	74	—	—	—
		Screw speed min ⁻¹	500			400			—		
		Nozzle touch force kN {tf}	14.8 {1.5}			14.8 {1.5}			19.7 {2.0}		
		Nozzle stroke from platen mm	50								
		Type of nozzle	Open nozzle								
		Cylinder temperature control	Cylinder 3 / Nozzle 2			Cylinder 4 / Nozzle 2					
Heater wattage kW		3.9			5.5			9.2			
Mechanism		Double toggle									
Clamping force kN {tf}		834 {85}									
Daylight opening (Max.) mm		710									
Opening stroke (Max.) mm	300										
Mold height mm	180~410										
Distance between tie-bars (H×V) mm	410×360										
Platen size (H×V) mm	580×530										
Ejector point	5 points										
Ejector force kN {tf}	32.4 {3.3}										
Ejector stroke mm	80										
General	Machine weight t	3.9			3.9			4.0			
	Machine dimensions (L×W×H) m	4.14×1.12×1.59			4.14×1.12×1.59			4.35×1.12×1.62			

Remarks:

1. Maximum injection pressure and maximum holding pressure may be restricted due to molding condition.
2. The theoretical injection capacity is (cross sectional area of cylinder) × (stroke of screw).
3. The injection capacity is applicable for GP-PS and variable according to the grade of resin, molding conditions and mold.
4. The plasticizing rate is applicable for GP-PS.
5. PC, HPVC, other engineering plastic, etc., low temperature setting and high speed molding may require a high torque depending on the grade or molding conditions. Please contact us if you plan.

Note:

1. Due to continual improvements, specifications are subject to change without notice.
2. Actual figures of the specification will vary depending on final machine configuration. Please contact us if you require more specific data.
3. Performance specifications are based on theoretical data.
4. High speed injection and Ultra speed injection are optional.
5. 1MPa=10.2 kgf/cm², 1kN=0.102tf

Equipment Dimensions and Mold Related Dimensions

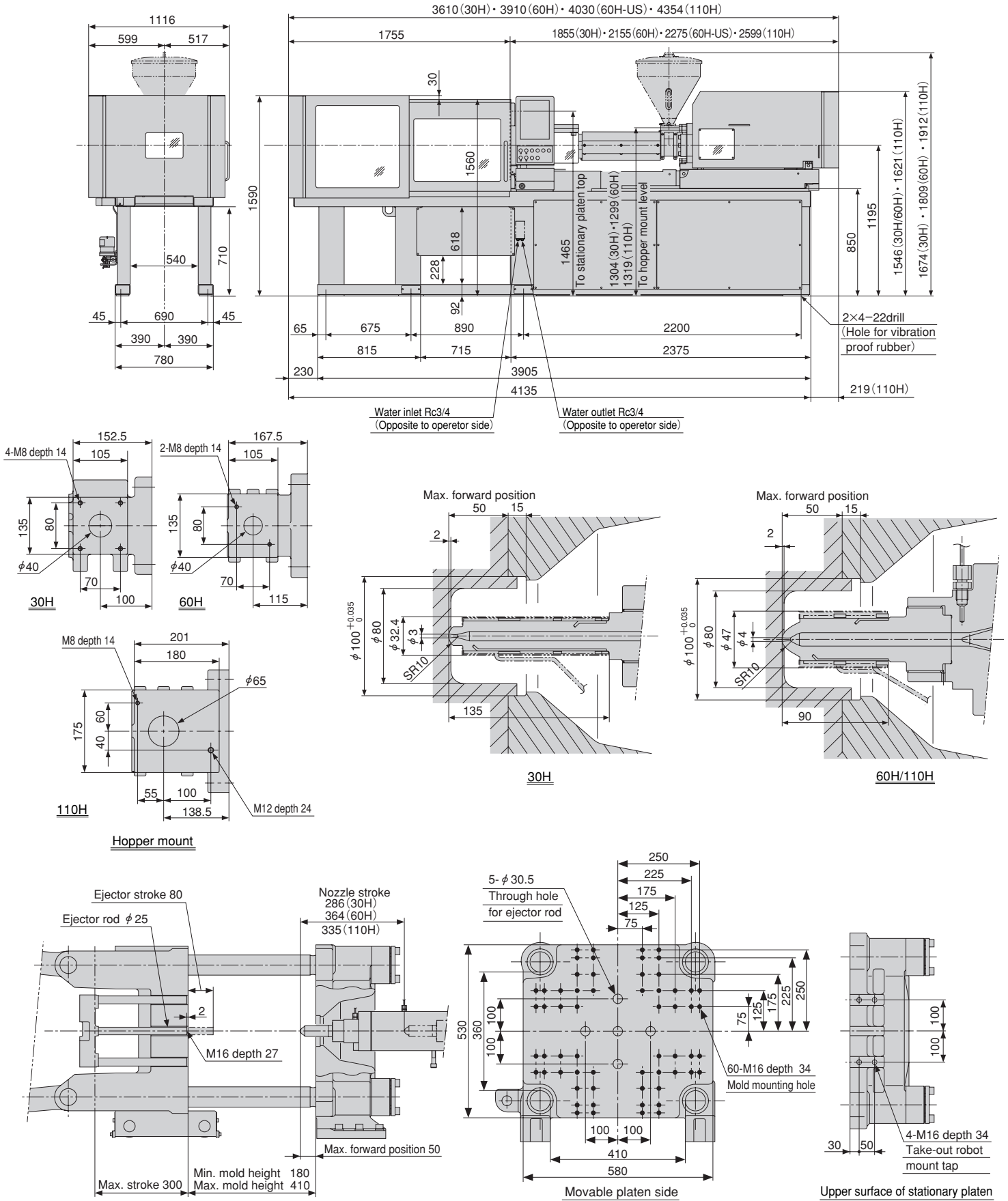

Performance Table

Unit	Item	J110AD										
		60H			110H			180H				
General Unit	Model	60H			110H			180H				
	Screw cylinder type	K	A	B	K	A	B	K	A	B		
	Screw diameter mm	25	28	32	32	35	40	35	40	45		
	Screw stroke mm	100			120			140				
	Theoretical injection capacity cm ³	49	62	80	97	115	151	135	176	223		
	Injection capacity (GP-PS) g	45	56	73	88	105	137	123	160	203		
	Standard	Injection pressure(Max.) MPa {kgf/cm ² }	270 {2750}	215 {2190}	165 {1680}	270 {2750}	225 {2290}	172 {1750}	260 {2650}	199 {2020}	157 {1600}	
		Holding pressure(Max.) MPa {kgf/cm ² }	245 {2490}	195 {1980}	150 {1530}	245 {2490}	205 {2090}	157 {1600}	236 {2400}	181 {1840}	143 {1450}	
		Injection speed mm/s	350			350			350			
		Injection rate cm ³ /s	172	216	281	281	337	440	337	440	557	
		Plasticizing rate (GP-PS) kg/h	34	46	74	74	92	123	92	127	166	
		Screw speed min ⁻¹	400			400			400			
		Injection Unit	High speed (HS)	Injection pressure(Max.) MPa {kgf/cm ² }	270 {2750}	215 {2190}	165 {1680}	—	—	—	—	—
	Holding pressure(Max.) MPa {kgf/cm ² }			245 {2490}	195 {1980}	150 {1530}	—	—	—	—	—	
	Injection speed mm/s			500			—			—		
	Injection rate cm ³ /s			245	308	402	—	—	—	—	—	—
	Plasticizing rate (GP-PS) kg/h			34	46	74	—	—	—	—	—	—
	Ultra speed (US)	Screw speed min ⁻¹	400	400			—			—		
			Injection pressure(Max.) MPa {kgf/cm ² }	270 {2750}	215 {2190}	165 {1680}	—	—	—	—	—	—
			Holding pressure(Max.) MPa {kgf/cm ² }	245 {2490}	195 {1980}	150 {1530}	—	—	—	—	—	—
			Injection speed mm/s	800			—			—		
			Injection rate cm ³ /s	393	493	643	—	—	—	—	—	—
	General Unit	Plasticizing rate (GP-PS) kg/h	34	46	74	—	—	—	—	—	—	
		Screw speed min ⁻¹	400			—			—			
		Nozzle touch force kN {tf}	14.8 {1.5}			19.7 {2.0}			19.7 {2.0}			
		Nozzle stroke from platen mm	50									
		Type of nozzle	Open nozzle									
Cylinder temperature control		Cylinder 4 / Nozzle 2										
Heater wattage kW		5.5			9.2			10.2				
Clamping Unit		Mechanism	Double toggle									
		Clamping force kN {tf}	1080 {110}									
		Daylight opening (Max.) mm	800									
	Opening stroke (Max.) mm	350										
	Mold height mm	200~450										
	Distance between tie-bars (H×V) mm	460×410										
	Platen size (H×V) mm	660×610										
	Ejector point	5 points										
General Unit	Ejector force kN {tf}	32.4 {3.3}										
	Ejector stroke mm	100										
	Machine weight t	4.8			4.9			4.9				
Machine dimensions (L×W×H) m	4.38×1.16×1.68			4.58×1.16×1.68			4.61×1.16×1.68					

Remarks:

1. Maximum injection pressure and maximum holding pressure may be restricted due to molding condition.
2. The theoretical injection capacity is (cross sectional area of cylinder) × (stroke of screw).
3. The injection capacity is applicable for GP-PS and variable according to the grade of resin, molding conditions and mold.
4. The plasticizing rate is applicable for GP-PS.
5. PC, HPVC, other engineering plastic, etc., low temperature setting and high speed molding may require a high torque depending on the grade or molding conditions. Please contact us if you plan.

Note:

1. Due to continual improvements, specifications are subject to change without notice.
2. Actual figures of the specification will vary depending on final machine configuration. Please contact us if you require more specific data.
3. Performance specifications are based on theoretical data.
4. High speed injection and Ultra speed injection are optional.
5. 1MPa=10.2 kgf/cm², 1kN=0.102tf

Equipment Dimensions and Mold Related Dimensions

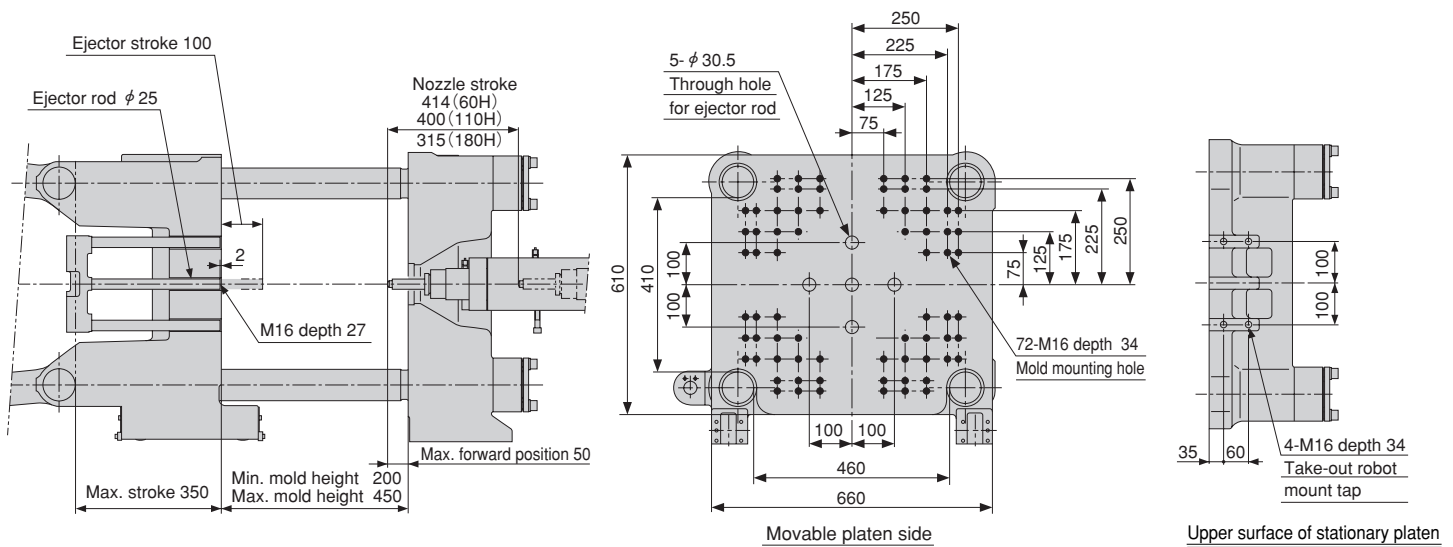
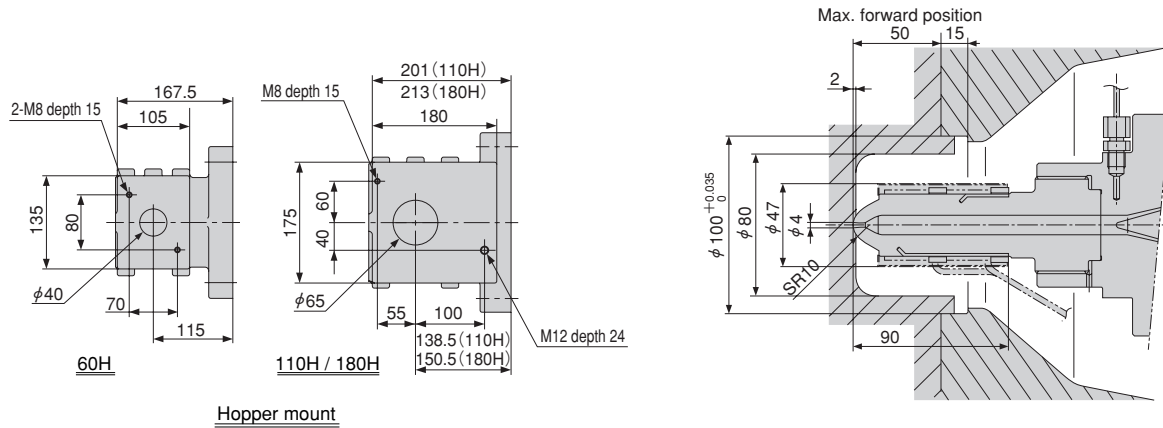
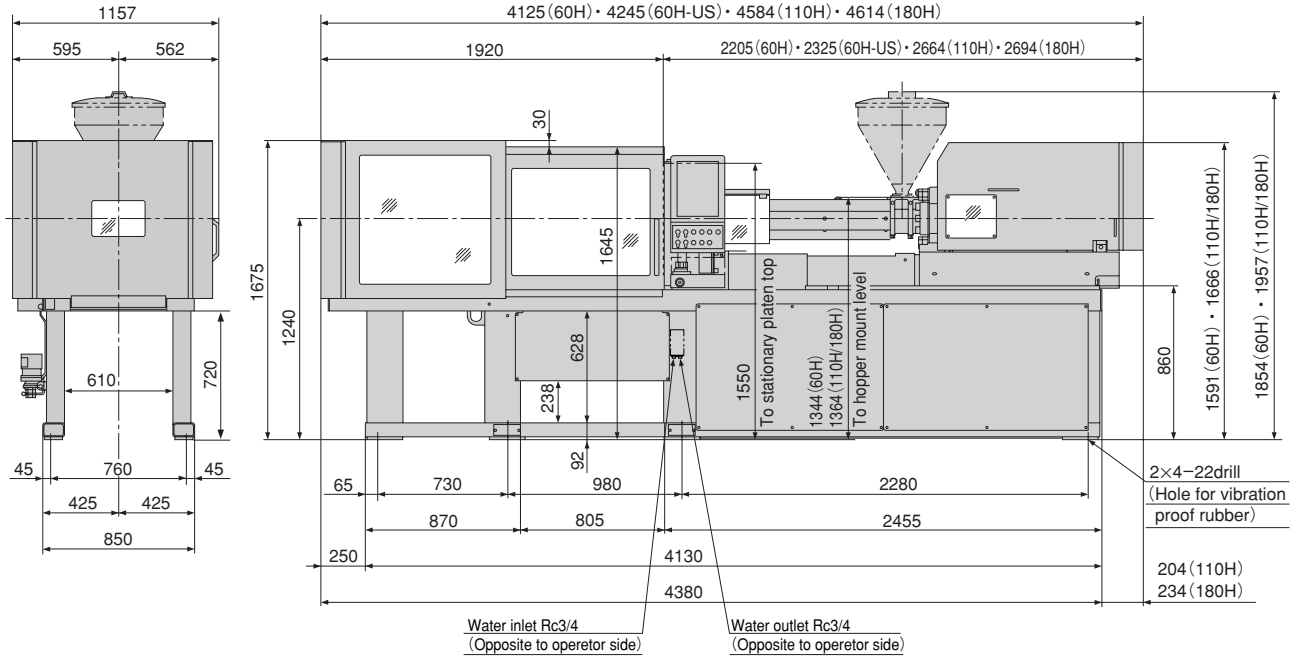

Performance Table

Unit	Model	J140AD								
		60H			110H			180H		
Item		K	A	B	K	A	B	K	A	B
Screw cylinder type		K	A	B	K	A	B	K	A	B
Screw diameter	mm	25	28	32	32	35	40	35	40	45
Screw stroke	mm	100			120			140		
Theoretical injection capacity	cm ³	49	62	80	97	115	151	135	176	223
Injection capacity (GP-PS)	g	45	56	73	88	105	137	123	160	203
Standard	Injection pressure(Max.) MPa {kgf/cm ² }	270 {2750}	215 {2190}	165 {1680}	270 {2750}	225 {2290}	172 {1750}	260 {2650}	199 {2020}	157 {1600}
	Holding pressure(Max.) MPa {kgf/cm ² }	245 {2490}	195 {1980}	150 {1530}	245 {2490}	205 {2090}	157 {1600}	236 {2400}	181 {1840}	143 {1450}
	Injection speed	350			350			350		
	Injection rate	172	216	281	281	337	440	337	440	557
	Plasticizing rate (GP-PS) kg/h	34	46	74	74	92	123	92	127	166
	Screw speed	400			400			400		
	Injection Unit High speed (HS)	Injection pressure(Max.) MPa {kgf/cm ² }	270 {2750}	215 {2190}	165 {1680}	—	—	—	—	—
Holding pressure(Max.) MPa {kgf/cm ² }		245 {2490}	195 {1980}	150 {1530}	—	—	—	—	—	—
Injection speed		500			—			—		
Injection rate		245	308	402	—	—	—	—	—	—
Plasticizing rate (GP-PS) kg/h		34	46	74	—	—	—	—	—	—
Injection Unit Ultra speed (US)	Injection pressure(Max.) MPa {kgf/cm ² }	270 {2750}	215 {2190}	165 {1680}	—	—	—	—	—	—
	Holding pressure(Max.) MPa {kgf/cm ² }	245 {2490}	195 {1980}	150 {1530}	—	—	—	—	—	—
	Injection speed	800			—			—		
	Injection rate	393	493	643	—	—	—	—	—	—
	Plasticizing rate (GP-PS) kg/h	34	46	74	—	—	—	—	—	—
Screw speed	400			—			—			
Nozzle touch force	kN {tf}	14.8 {1.5}			19.7 {2.0}			19.7 {2.0}		
Nozzle stroke from platen	mm	50								
Type of nozzle		Open nozzle								
Cylinder temperature control		Cylinder 4 / Nozzle 2								
Heater wattage	kW	5.5			9.2			10.2		
Clamping Unit	Mechanism	Double toggle								
	Clamping force	1370 {140}								
	Daylight opening (Max.)	850								
	Opening stroke (Max.)	400								
	Mold height	200~450								
	Distance between tie-bars (H×V)	530×460								
	Platen size (H×V)	780×660								
	Ejector point	5 points								
Ejector force	32.4 {3.3}									
Ejector stroke	100									
General	Machine weight	6.3			6.4			6.5		
	Machine dimensions (L×W×H) m	4.77×1.26×1.79			4.91×1.26×1.79			4.98×1.26×1.79		

Remarks:

1. Maximum injection pressure and maximum holding pressure may be restricted due to molding condition.
2. The theoretical injection capacity is (cross sectional area of cylinder) × (stroke of screw).
3. The injection capacity is applicable for GP-PS and variable according to the grade of resin, molding conditions and mold.
4. The plasticizing rate is applicable for GP-PS.
5. PC, HPVC, other engineering plastic, etc., low temperature setting and high speed molding may require a high torque depending on the grade or molding conditions. Please contact us if you plan.

Note:

1. Due to continual improvements, specifications are subject to change without notice.
2. Actual figures of the specification will vary depending on final machine configuration. Please contact us if you require more specific data.
3. Performance specifications are based on theoretical data.
4. High speed injection and Ultra speed injection are optional.
5. 1MPa=10.2 kgf/cm², 1kN=0.102tf

Equipment Dimensions and Mold Related Dimensions

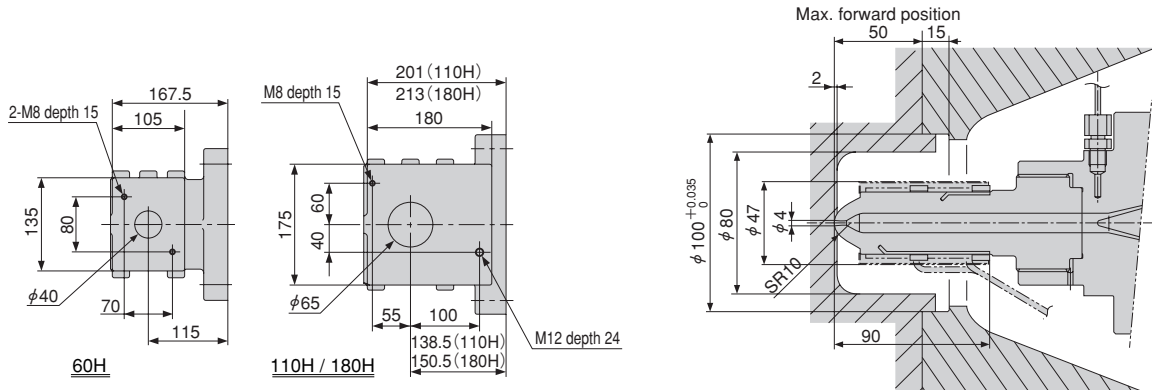
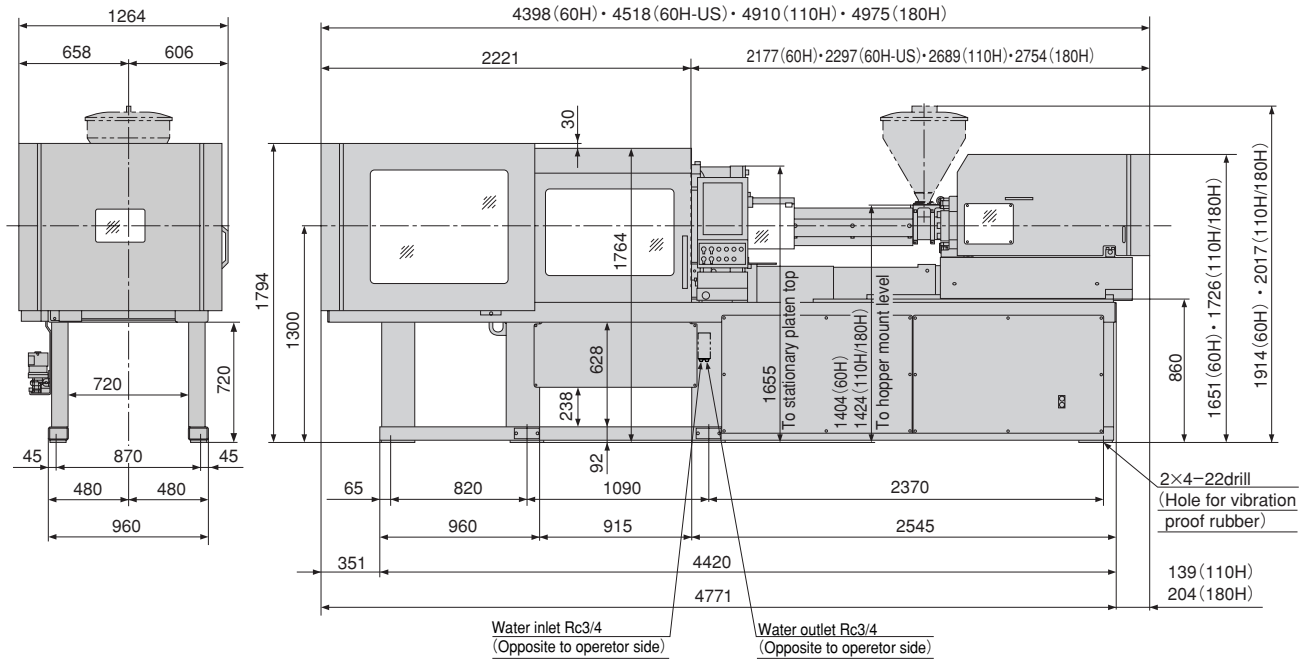

Hopper mount

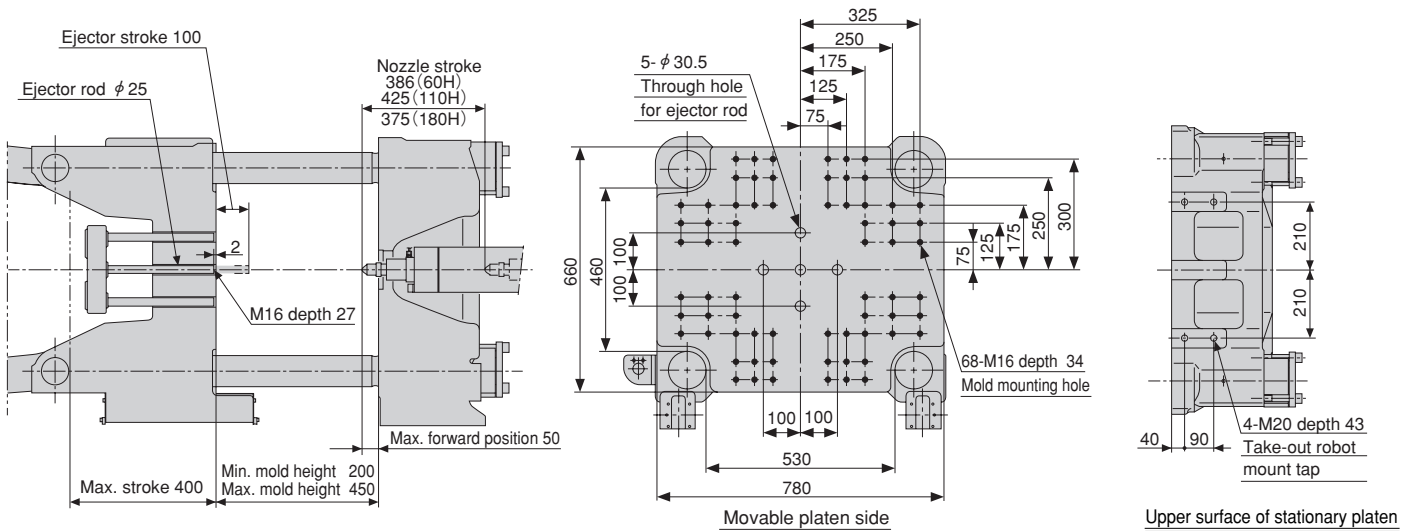

Performance Table

Unit	Model	J180AD								
		110H			180H			300H		
Item		K	A	B	K	A	B	K	A	B
Screw cylinder type		K	A	B	K	A	B	K	A	B
Screw diameter	mm	32	35	40	35	40	45	40	46	51
Screw stroke	mm	120			140			180		
Theoretical injection capacity	cm ³	97	115	151	135	176	223	226	299	368
Injection capacity (GP-PS)	g	88	105	137	123	160	203	206	273	335
Standard	Injection pressure(Max.) MPa {kgf/cm ² }	270 {2750}	225 {2290}	172 {1750}	260 {2650}	199 {2020}	157 {1600}	250 {2550}	189 {1920}	154 {1570}
	Holding pressure(Max.) MPa {kgf/cm ² }	245 {2490}	205 {2090}	157 {1600}	236 {2400}	181 {1840}	143 {1450}	227 {2310}	172 {1750}	140 {1420}
	Injection speed	350			350			240		
	Injection rate	281	337	440	337	440	557	302	399	490
	Plasticizing rate (GP-PS) kg/h	74	92	123	92	127	166	130	184	232
	Screw speed	400			400			400		
	Injection Unit High speed (HS)	Injection pressure(Max.) MPa {kgf/cm ² }	—	—	—	—	—	—	250 {2550}	189 {1920}
Holding pressure(Max.) MPa {kgf/cm ² }		—	—	—	—	—	—	227 {2310}	172 {1750}	140 {1420}
Injection speed		—			—			330		
Injection rate		—	—	—	—	—	—	415	548	674
Plasticizing rate (GP-PS) kg/h		—	—	—	—	—	—	130	184	232
Injection Unit Ultra speed (US)	Screw speed	—			—			400		
	Injection pressure(Max.) MPa {kgf/cm ² }	—	—	—	—	—	—	—	—	—
	Holding pressure(Max.) MPa {kgf/cm ² }	—	—	—	—	—	—	—	—	—
	Injection speed	—			—			—		
	Injection rate	—	—	—	—	—	—	—	—	—
General	Plasticizing rate (GP-PS) kg/h	—	—	—	—	—	—	—	—	—
	Screw speed	—			—			—		
	Nozzle touch force	19.7 {2.0}			19.7 {2.0}			24.6 {2.5}		
	Nozzle stroke from platen	50								
	Type of nozzle	Open nozzle						Open nozzle (tip type)		
Cylinder temperature control	Cylinder 4 / Nozzle 2						Cylinder 4 / Nozzle 1			
Heater wattage	9.2			10.2			13.0			
Clamping Unit	Mechanism	Double toggle								
	Clamping force	1770 {180}								
	Daylight opening (Max.)	950								
	Opening stroke (Max.)	450								
	Mold height	200~500								
	Distance between tie-bars (H×V)	590×530								
	Platen size (H×V)	840×780								
	Ejector point	9 points								
Ejector force	34.3 {3.5}									
Ejector stroke	130									
General	Machine weight	9.0			9.0			9.5		
	Machine dimensions (L×W×H) m	5.22×1.36×1.92			5.22×1.36×1.92			5.51×1.36×1.92		

Remarks:

- Maximum injection pressure and maximum holding pressure may be restricted due to molding condition.
- The theoretical injection capacity is (cross sectional area of cylinder) × (stroke of screw).
- The injection capacity is applicable for GP-PS and variable according to the grade of resin, molding conditions and mold.
- The plasticizing rate is applicable for GP-PS.
- PC, HPVC, other engineering plastic, etc., low temperature setting and high speed molding may require a high torque depending on the grade or molding conditions. Please contact us if you plan.

Note:

- Due to continual improvements, specifications are subject to change without notice.
- Actual figures of the specification will vary depending on final machine configuration. Please contact us if you require more specific data.
- Performance specifications are based on theoretical data.
- High speed injection and Ultra speed injection are optional.
- 1MPa=10.2 kgf/cm², 1kN=0.102tf

Equipment Dimensions and Mold Related Dimensions

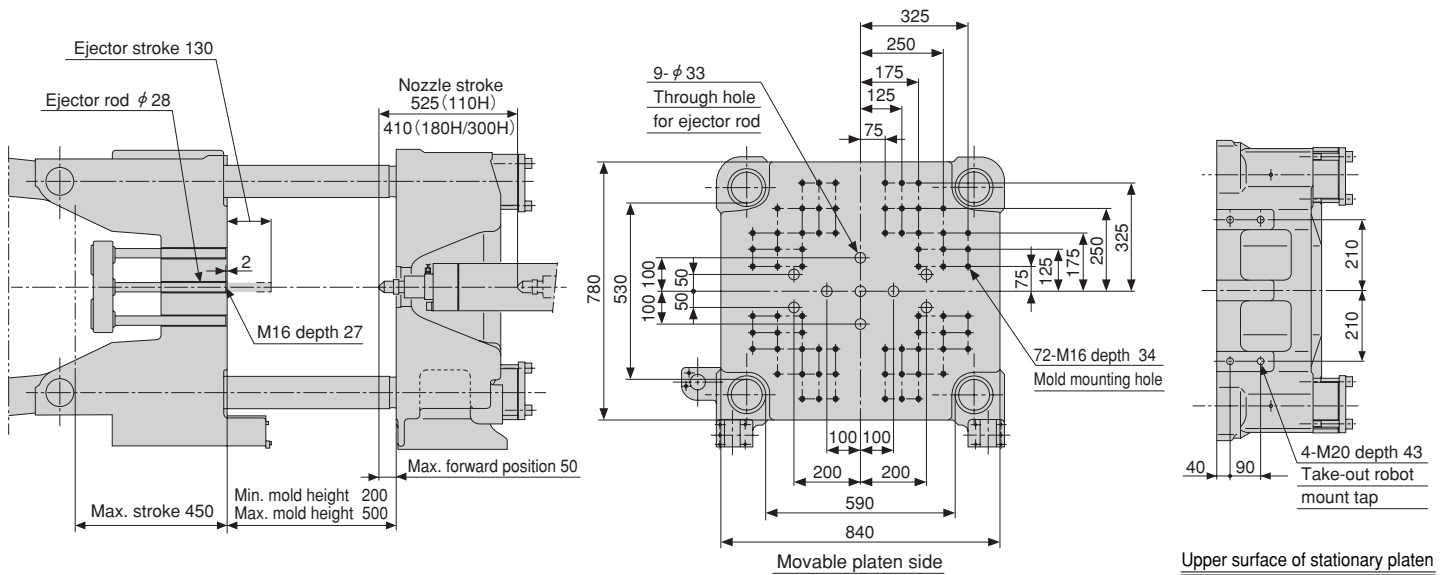
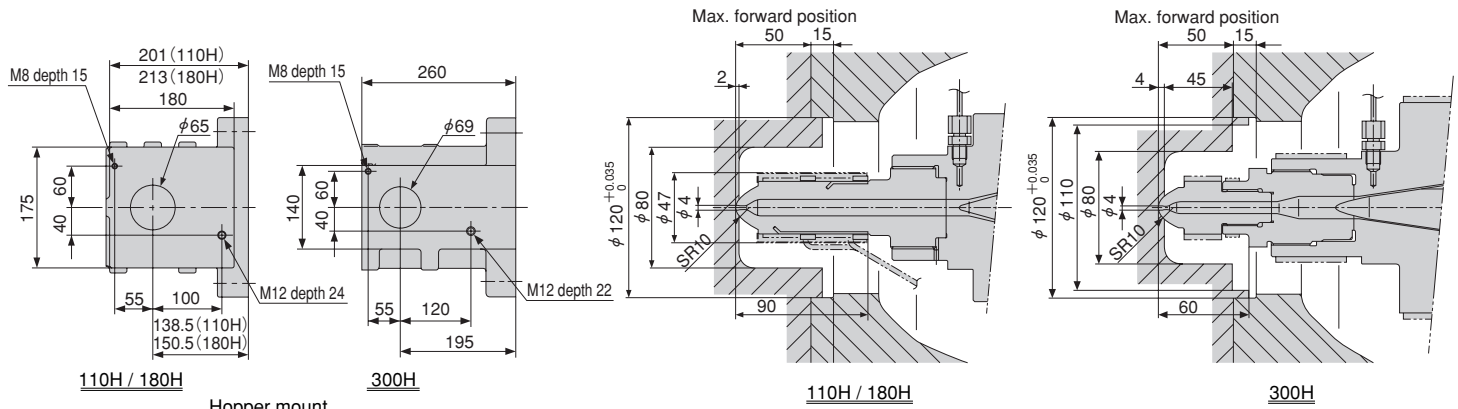
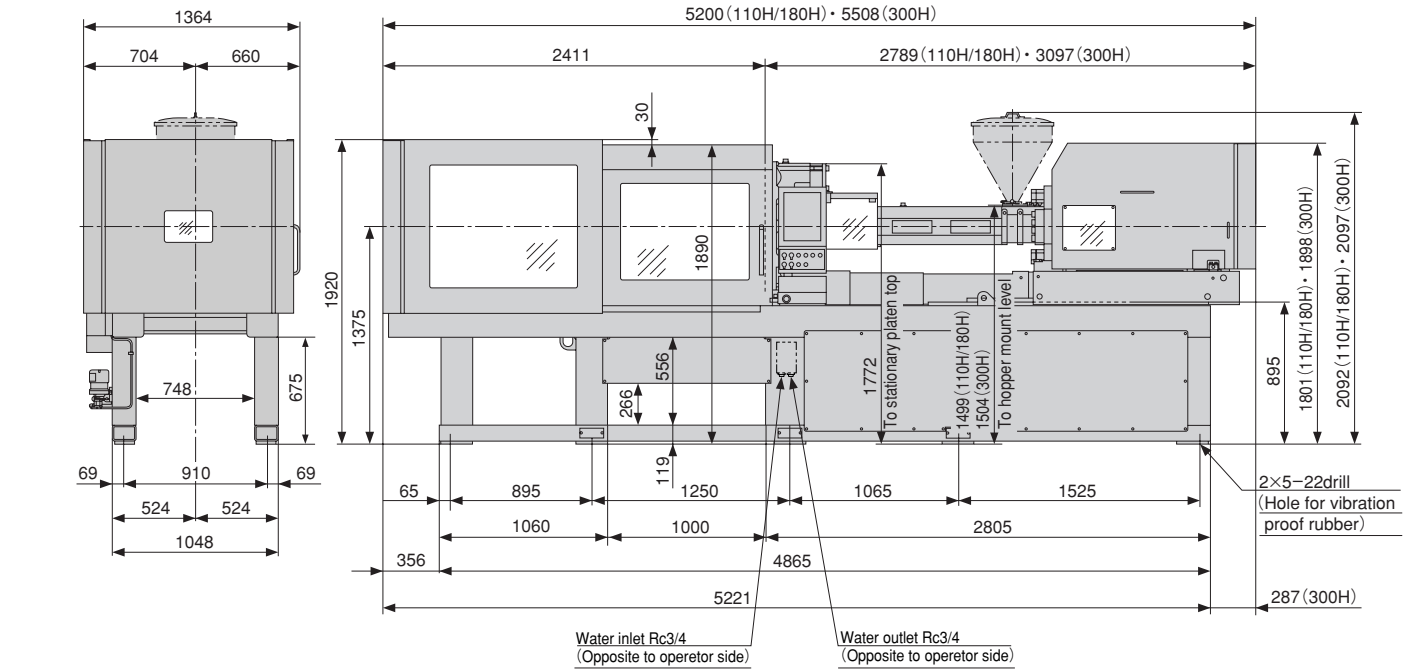

Standard equipment

Item		
Injection unit	KC nozzle (Injection units up to 180H) (Note 1)	
	N2000F barrel (Note 2)	
	Corrosion and abrasion-resistant screw (Injection units up to 180H)	
	Cr-plated screw (Injection unit 300H)	
	Screw pull-back	
	Purge cover (with a limit switch)	
	Injection unit swiveling device (with a limit switch)	
	Screw cold start prevention	
	Molding/Pause temperature select	
	Auto purging circuit	
	Nozzle retract select	
	Pull-back select	
	Auto grease lubrication	
	Injection/Metering programmed control	Injection/Holding pressure:1 to 6 steps (Variable) Metering/Back pressure:1 to 3 steps (Variable)
	Holding pressure transfer by speed detection (IVS control)	
	Barrel temperature remote setting	
	Barrel temperature control (SSR)	
	Soft Pack Servo control	
	Hopper flange temperature control	
	IWCS control	
Reverse seal control		
Holding pressure control select		
Synchronous temperature rise control		
Clamping unit	Grease-free toggle bushing	
	Auto grease lubrication	
	High-performance platen support	
	Wider platens	
	Flat press platen mechanism (Stationary side/Movable side)	
	Tie bar pre-tensioning mechanism	
	Mold open/close and ejection programmed control	Mold open/close: 4 steps (Fixed) Ejection: 1 to 3 steps (Variable)
	Electric-driven mold thickness adjusting device	
	Mold thickness remote setting	
	Auto clamping force setting	
	Toggle type injection compression function	A-mode B-mode Compression: 1 to 6 steps (Variable)
	Mold protection function	
	Clamping safety device (electrical/mechanical)	
	Robot mounting holes	

Item	
Controller	Touch panel 15" TFT color LCD controller
	120 mold conditions storage (Internal memory) (Note 3)
	Soft start molding
	USB printer port (Note 4)
	Self diagnostics function
	Overall setting screen
	Help function
	Pop-up display
	Pre-heat timer
	Compound action
Monitor	Clock
	Attended/Unattended operation select
	Product takeout robot circuit
	Multi-language select (English, Chinese, Japanese)
	Injection pressure overshoot alarm
	Grease lubrication fault alarm
	Servo fault alarm
	Fault alarm buzzer
	Statistical graph
	Actual value display
	Mold temperature display (Note 5)
	Cumulative operating hour display
	Barrel temperature monitor
	Injection pressure monitor (IPM)
	Oscillograph waveform monitor
	Injection/Metering waveform monitor
	Production monitor
	Cycle monitor
Molding condition upper/lower limit monitor (Note 6)	
Injection/Metering waveform storage	
Heater system fault	
Inspection and maintenance (Note 7)	
Alarm history	
Set value history	
Others	Cooling water closed circuit (with a flow indicator)
	Accessories (Maintenance tools and Ejector rods)

(Note)

- Nozzle of injection unit 300H, tip type nozzle is equipped as standard.
- One set of K, A or B type is equipped as standard.
- The external memory is capable of storing conditions for 1000 molds.
Prepare commercial USB data storage media.
- The printer and the printer cables are options.
- Temperature sensors and electric wiring are not included.
- A maximum of 8 items and alarms can be selected out of the following monitor items.
 - Cycle time
 - Injection time
 - Metering time
 - Cushion position
 - Holding pressure end position
 - Injection pressure
 - Holding pressure transfer pressure
 - Screw back pressure
 - Metering end position
 - Injection start position
 - Holding pressure transfer position
 - Mold open time
 - Mold close time
 - Metering torque
 - Holding pressure transfer speed
 - Mold inner pressure <option>
- Indicates inspection times and items.

Options list

Item	
Injection unit	Long nozzle
	Various shut-off nozzles (Note 1)
	KC nozzle (Injection unit 300H)
	M7 screw (High plasticization type) (Note 2)
	HP screw (High dispersion type) (Note 2)
	Corrosion and abrasion-resistant screw (Injection unit 300H)
	Cr-plated screw (Injection units up to 180H)
	One set of screws and barrels for molding optical products
	Special screw (Note 3)
	HT screw head
	One set of screws and barrels for high temperature molding of super engineered plastics
	Barrel insulation cover
	Barrel blower cooling unit
	Hopper (Option for all the region)
	Hopper swiveling device
Clamping unit	Ultra speed injection (Excl. injection units 110H, 180H and 300H) (Note 4)
	High-speed injection (Excl. injection units 110H and 180H) (Note 5)
	High holding pressure molding (for long-time holding pressure molding) (Note 6)
	Vented barrel
	Daylight extension
	Thermal insulation plate for platens (Note 7)
	Various locating rings
	Air jet
	Core pull devices (Pneumatic type and Hydraulic type) (Note 8)
	Unscrewing motor circuit
	Ejector gate cutting device
	Ejector plate return confirmation circuit
	Valve gate device (Pneumatic type and Hydraulic type) (Note 8)
	Product drop detector (Photoelectric)
	Chute
Rejecting product detecting chute	
Mold setup device	
T-groove plate (Note 7)	
Magnet mold clamper (Note 7)	
Mold clamper	

Item	
Electrical instrumentation and control	Other language select (Korean, Spanish and French)
	Simple centralized monitor system LINK10 (Note 9)
	Centralized control system NET100 (Note 10)
	Heater burnout alarm
	Mold temperature display (with mold temperature upper/lower limit alarms)
	Mold temperature control device (with mold temperature upper/lower limit alarms)
	Printer (with a printer cable)
Other	Cooling water open circuit device
	Cooling water failure warning
	Leveling pad for installation
	Rotary warning light
	Export specification (Note 11)
Designated color (Note 12)	

(Note)

1. A spring type SVN shutoff nozzle, a pneumatic shut-off nozzle and a hydraulic shut-off nozzle can be mounted. For the hydraulic type, a separate hydraulic unit is needed. For injection units 180H or smaller, a pneumatic shut-off device is provided as a standard option. Regarding the hydraulic shut-off device, discussion is needed separately.
2. Regarding the M7 screw and the HP screw for the injection units 15H and 30H, discussion is needed separately.
3. Regarding special screws, contact us separately.
4. The ultra-speed injection specification applies to the injection units 15H, 30H and 60H.
5. The high-speed injection specification applies to the injection units 15H, 30H, 60H and 300H. The injection speed differs depending on injection unit.
6. The motor is prevented from being overloaded in a long holding time and high holding pressure molding condition.
7. When applied, extended nozzle is required. Note that the usable mold thickness range will change.
8. For the hydraulic type, a separate hydraulic unit is needed.
9. The LINK10 has actual data collection, molding condition control and remote control functions.
10. The NET100 has quality control and production control functions in addition to the functions that the LINK10 has.
11. Regarding the export specifications, separate discussion is needed in some cases, depending upon the export destination.
12. Designate colors, referring to color samples or Munsell codes.

Utilities

■ Total Power Capacity

Machine Model		Total Power Capacity (kVA)		
		Standard Injection	High Speed Injection	Ultra Speed Injection
J35AD	15H	3.9	4.3	5.0
	30H	5.8	6.5	7.3
J55AD	15H	4.3	4.7	5.4
	30H	6.2	6.9	7.7
	60H	9.1	9.9	11.3
J85AD	30H	6.2	6.9	7.7
	60H	9.1	9.9	11.3
	110H	14.1	—	—
J110AD	60H	9.3	10.1	11.5
	110H	14.3	—	—
	180H	19.8	—	—
J140AD	60H	9.7	10.5	11.9
	110H	14.7	—	—
	180H	20.1	—	—
J180AD	110H	16.2	—	—
	180H	19.8	—	—
	300H	20.1	27.5	—

Note: 1. Total power capacity does not include external outlets.

2. We recommend that the rated interrupting current of the main power supply breaker is more than 25 kA at AC400V/460V.

■ Cooling Water Capacity for Barrel Temperature Control

Machine Model	Cooling Water Capacity for Barrel Temperature control (m ³ /h)
15H	0.2
30H	
60H	0.3
110H	
180H	
300H	0.4

Note: The above figures do not include the required quantity of water for the mold temperature controller.